

ISA Connector

Mechanical

Contact Retention Force: 1.80kgf min.
Mating Force: 340gf max. per Contact Pair
Unmating Force: 28gf min. per Contact Pair
Durability: 500 Cycles

Electrical

Current Rating: 3A max.
Current Voltage: 250V
Contact Resistance: 15mΩ max. initial
Dielectric Withstanding Voltage: 1000V
Insulation Resistance: 5000MΩ min.

Physical

Housing: Thermoplastic, UL 94V-0 rated, in Black Color
Contact: Copper alloy
Plating: See "ORDERING INFORMATION"
Operating Temperature: -55 °C to +85 °C

**ES Series
Vertical Type
2.54mm [.100"] Pitch
98 Pos.**

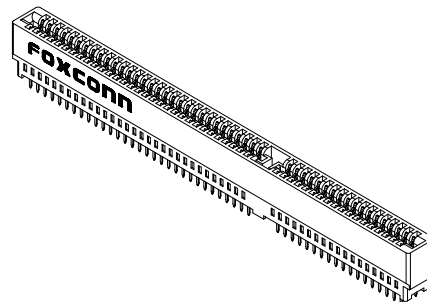

DRAWING

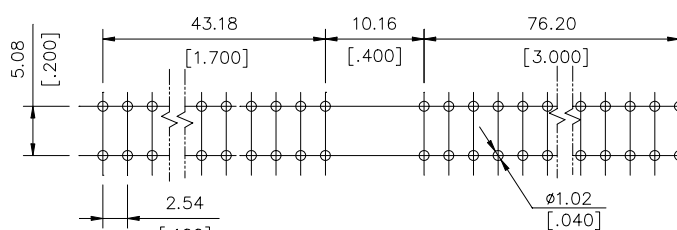
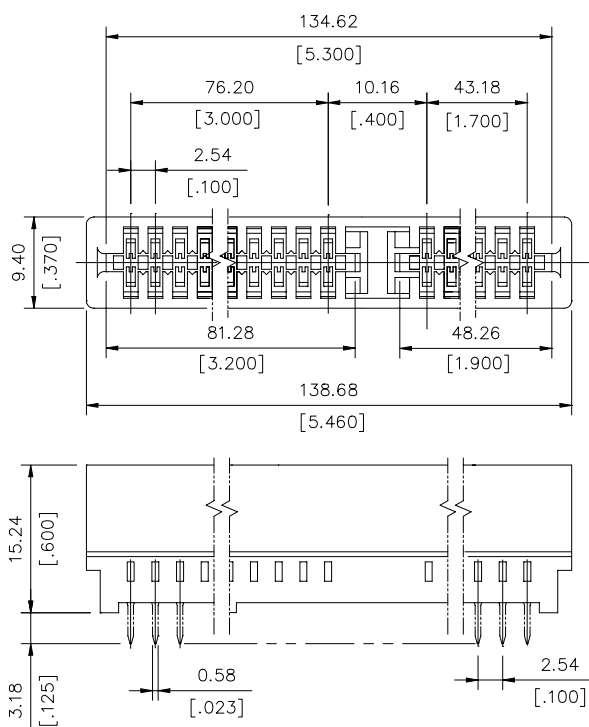

RECOMMENDED P.C.B. LAYOUT

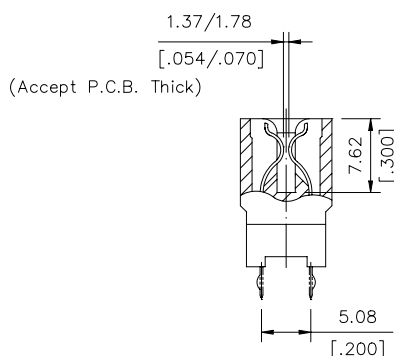

ORDERING INFORMATION

PRODUCT NO.: ES 0 4 9 0 *

Series Prefix
2.54 [.100] Pitch
Edge Card Conn.

Termination Type
0=Straight

No.of Pos.
49=98 Pos.

Contact Area Plating

1=Gold Flash
2=20u" Gold
3=30u" Gold
6=10u" Gold
7=15u" Gold

Tail Length Type
0=3.18 [.125]

ES0490*-K0(*)	Without Kink
ES0490*(*)	5-6,51-54,93-94
P/N	Kink Pos.